

**Use**

- Never lift with a twisted chain.
- Use shortening hooks, knotting is not allowed.
- Use edge protectors to prevent sharp edges from damaging the chain.

See website or user instructions for assembly instructions.

Meets listed current specifications and standards at time of publication of this catalog.

**Maintenance**

Periodic thorough examination must be carried out at least every 12 months or more frequently according to local statutory regulations, type of use and past experience.

1. Overloaded chain slings must be taken out of service.
2. Chain and components including load pins which have been damaged, deformed, elongated, bent or showing signs of cracks or gouges shall be replaced. Carefully grind away small nicks and burrs.
3. Additional testing by magnetic particle inspection and/or proof loading at max. 2 x WLL may be carried out. The wear of the chain and component shall in no place exceed 10% of the original dimensions.
4. The chain link wear - max. 10% - is defined as the reduction of the mean diameter measured in two directions.

**Severe Environment**

Chain and components must not be used in alkaline (>pH10) or acidic conditions (<pH6). Comprehensive and regular examination must be carried out when used in severe or corrosive inducing environments. In uncertain situations consult your Gunnebo Industries dealer.

**Extreme Temperature Conditions**

The in service temperature effects the WLL as following :

Temperature (°F)	Reduction of WLL			
	Grade 10 chain (400)	Grade 10 chain (200)	Grade 10 components	Grade 8 chain & components
-40 to +392 °F	0 %	0 %	0 %	0 %
+392 to +572 °F	10 %	Not allowed	10 %	10 %
+572 to +752 °F	25 %	Not allowed	25 %	25 %

After short heat exposure, maximum one hour, the sling reverts to its full capacity. Upon return to normal temperature, the sling reverts to its full capacity within the above temperature range. Chain slings should not be used above or below these temperatures. **For chain grade 10(200) the maximum in service temperature is 200° C.**

**Definitions**

**Proof force:**

Each individual chain link is tested to the Manufacturing Proof Force (MPF) level before delivery. The MPF level is 2.5 times the WLL, equal to 62.5% of the Minimum Breaking Force.

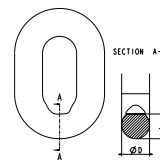

$$\frac{D + d}{2} > 0.9d_n$$

**Breaking force (BF):**

The highest static force a chain is exposed to during test loading before breaking.

**Working load limit (WLL):**

The maximum permitted load on a lifting chain under normal (vertical) lifting conditions.

**Total ultimate elongation:**

The elongation of the test item, relative to the original length, at the moment of breaking.